

DIN 933 Hexagon Head Setscrew

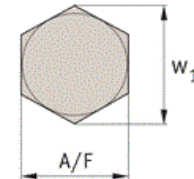
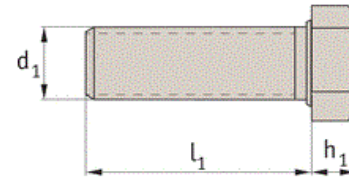

Din 933 Hexagon Head Setscrew															
Thread	M2	M2.5	M3	M3.5	M4	M5	M6	M8	M10	M12	M14	M16	M18	M20	M24
h1	1.6	2.1	2.3	2.6	3	3.8	4.7	5.3	6.4	7.5	8.8	10	11.5	12.5	15
A/F	3.2	4	5	5.5	7	8	10	13	16	18	21	26	27	30	36
W1	3.38	4.28	5.4	5.96	7.59	8.71	11.05	14.38	17.77	20.03	23.3	26.7	30.1	33.5	39.9
Listed Lengths = L1															
↑	4	4	4	5	6	5	5	6	6	10	20	20	20	20	20
	To	To	To	To	To	To	To	To	To	To	To	To	To	To	To
↓	25	25	35	35	30	70	80	130	130	130	150	150	150	150	150

Please Enquire With Regards To Length Availability

Material: Natural Nylon

INFORMATION AND DRAWINGS PROVIDED ARE FOR REFERENCE ONLY